

HTI

HOME TECHNOLOGY INTEGRATION

Motor, control and accessory specification guide

Introduction

This Somfy HTI Motor & Control selection guide presents a range of motors, controls and accessories specifically designed to deliver a high quality solution for the automation of Roller and Venetian blinds.

This guide focuses on two specific motor ranges, both of which have been designed for quiet operation:

• Sonesse 30



• Sonesse 40



Within both motor ranges there are numerous control options available to allow for flexibility when specifying the motor, based on the signal options from the home automation control system.

This guide also includes information on Somfy's RS485 controller, which operates on RS485 protocol and generates a Somfy RTS radio signal based on the programmed commands. This controller is ideal for projects with automation equipment communicating via RS485 protocol.



Blinds Specification & Assembly

The main purpose of this guide is to provide a clear indication of the quiet operation motors, controls and accessories required to specify and/or assemble a high quality motorised roller or venetian blind.

The Blind Specifier - To allow for the specification of specific motors, controls and accessories for a home automation project requiring motorised roller or venetian blinds and relay this information to the company responsible for the assembly and supply of the blinds.

The Blind Assembler - To identify and order the components required to fabricate a quiet operation motorised roller or venetian blind based on the specification submitted by the Blind Specifier.



As a member of Cedia we recognise that problems can arise when automation systems from different manufacturers are specified for a project. For that reason we are proactively working with leading manufacturers in the custom-install market to ensure Somfy products knit seamlessly with the leading third-party control systems.



Contents

- PAGE 4 · Sonesse 30 Range – Technical specification
- PAGE 5 · Sonesse 30 – Roller blind selection charts
 - Sonesse 30 – Roller blind system parts and commissioning tools
- PAGE 6 · Sonesse 30 – Venetian blind selection charts
 - Sonesse 30 – Venetian blind system parts and commissioning tools
- PAGE 7 · Sonesse 30 – Power supplies
 - Sonesse 30 DCT – Wiring and control scenarios
- PAGE 8 · Sonesse 30 – Power supplies
 - Sonesse 30 RTS – Wiring and control scenarios
- PAGE 9 · Sonesse 30 – Power supplies
 - Sonesse 30 RS485 – Wiring and control scenarios
- PAGE 10 · Sonesse 40 Range – Technical Specification
- PAGE 11 · Sonesse 40 – Roller blind selection charts
 - Sonesse 40 – Roller blind system parts and commissioning tools
- PAGE 12 · Sonesse 40 – Venetian blind selection charts
 - Sonesse 40 – Venetian blind system parts and commissioning tools
- PAGE 13 · Sonesse 40 WT – Wiring and control scenarios
- PAGE 14 · Sonesse 40 RTS – Wiring and control scenarios
- PAGE 15 · RS485 RTS Transmitter – Technical specification + wiring and control scenarios
- PAGE 16 · Dry Contact Transmitter – Technical specification + wiring and control scenarios
- PAGE 17 · RTS controls
- PAGE 18 · Order form

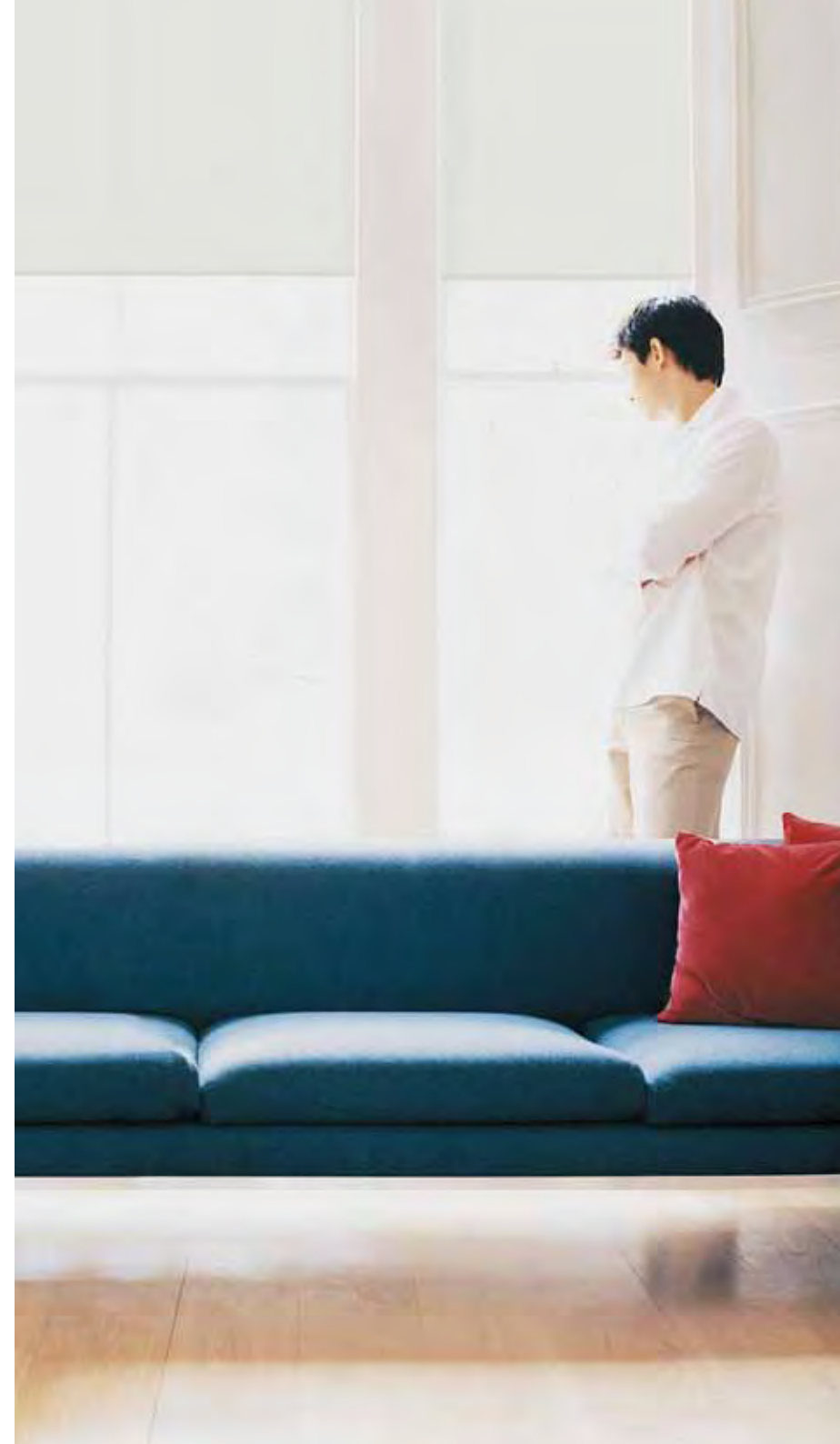

Sonesse 30 Range

TECHNICAL SPECIFICATION – SONESSE 30 DCT

Sonesse 30 DCT



Features & Benefits

24 Vdc quiet operation tubular motor incorporating an integral brake and electronic limit switch unit for accurate stopping positions. Suitable for use with aluminium tubes with minimum diameter of 31mm. The Sonesse 30 DCT motor is controlled via cry contact closure signalling.

DIMENSIONS

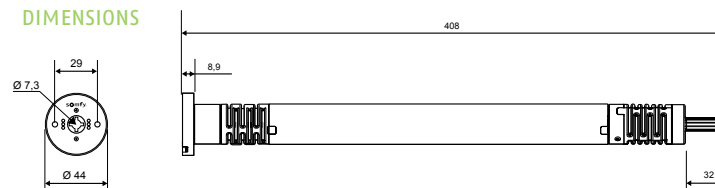

MOTOR FUNCTIONALITY

- Quiet motor
- Variable operating speed
- Intermediate position
- Slow start and stop
- Dry contact signalling
- 5 year warranty

TECHNICAL CHARACTERISTICS

Supply voltage	24 Vdc
Nominal load current	800 mA
Torque	2 NM
Nominal speed	28 r.p.m
Sound level	44 dBA
Limit switch capacity	60 revolutions
Operating temperature	0°C to 60°C
Protection factor	IP 30
Supply cable type	2 core 0.2mm ²
Control cable type	4 core 0.2mm ²
Supply/control cable length	2.5 M

TECHNICAL SPECIFICATION – SONESSE 30 RTS

Sonesse 30 RTS



Features & Benefits

24 Vdc quiet operation tubular motor incorporating an integral brake and electronic limit switch unit for accurate stopping positions. Suitable for use with aluminium tubes with minimum diameter of 31mm. The Sonesse 30 RTS motor is controlled via Somfy RTS radio signalling.

DIMENSIONS

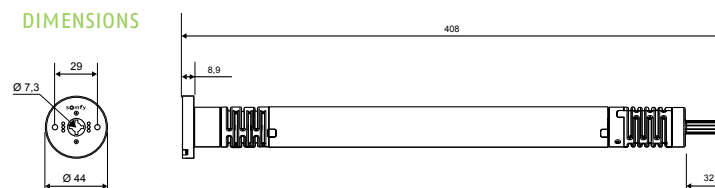

MOTOR FUNCTIONALITY

- Quiet motor
- Variable operating speed
- Intermediate position
- Slow start and stop
- RTS radio signalling
- 5 year warranty

TECHNICAL CHARACTERISTICS

Supply voltage	24 Vdc
Nominal load current	800 mA
Torque	2 NM
Nominal speed	28 r.p.m
Sound level	44 dBA
Limit switch capacity	120 revolutions
Operating temperature	0°C to 60°C
Protection factor	IP 30
Supply cable type	2 core 0.25mm ²
Supply cable length	2M

TECHNICAL SPECIFICATION – SONESSE 30 RS485

Sonesse 30 RS485



Features & Benefits

24 Vdc quiet operation tubular motor incorporating an integral brake and electronic limit switch unit for accurate stopping positions. Suitable for use with aluminium tubes with minimum diameter of 31mm. The Sonesse 30 RS485 motor is controlled via RS485 protocol

DIMENSIONS

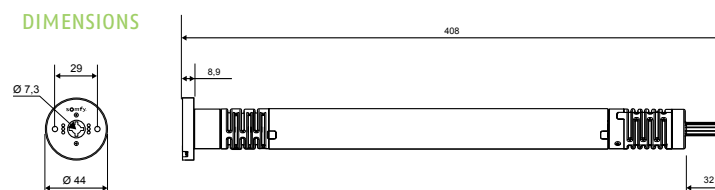

MOTOR FUNCTIONALITY

- Quiet motor
- Variable operating speed
- 16 Intermediate positions
- Slow start and stop
- RS485 signalling
- Dry contact signalling
- 5 year warranty

TECHNICAL CHARACTERISTICS

Supply voltage	24 Vdc
Nominal load current	800 mA
Torque	2 NM
Nominal speed	28 r.p.m
Sound level	44 dBA
Limit switch capacity	60 revolutions
Operating temperature	0°C to 60°C
Protection factor	IP 30
Supply cable type	2 core 0.2mm ²
RS485 cable type	3 core 0.2mm ²
DCT control cable type	4 core 0.2mm ²
Cable lengths	2.5 M

BLIND SELECTION CHARTS

The selection charts below are based on the specification of the Sonesse 30 2NM motor using Louvolite System 40[®] tube and fabric of varying weight. Maximum width of Louvolite System 40[®] tube is 2.5M.

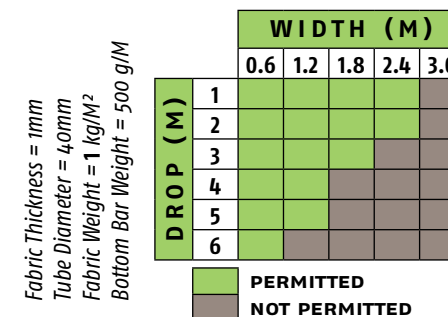
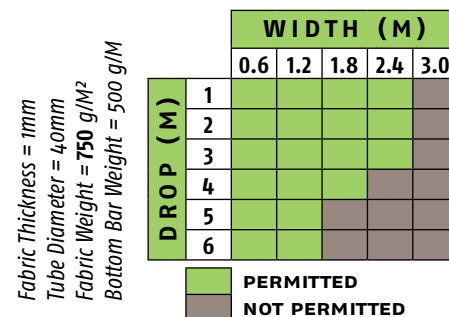
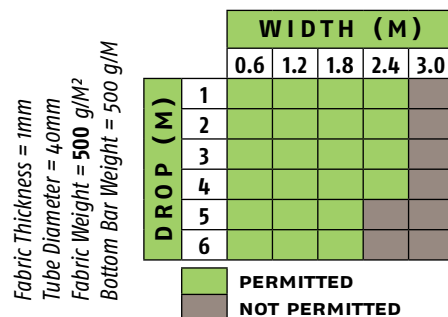
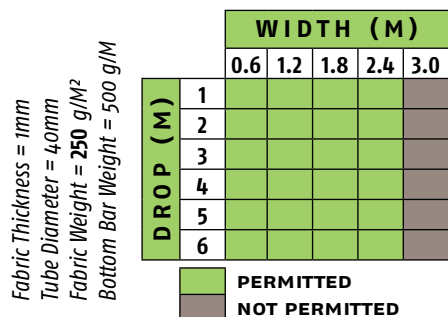

Contact Somfy Customer Services for guidance on motor selection based on specific fabric characteristics.

EXPLODED VIEW OF SONESSE 30 ROLLER BLIND SYSTEM

PARTS LIST

1	Sonesse 30 motor
2	Crown wheel
3	Drive wheel
4	Motor plate
5	Motor bracket
6	Idle end bracket
7	Idle end
8	Tube

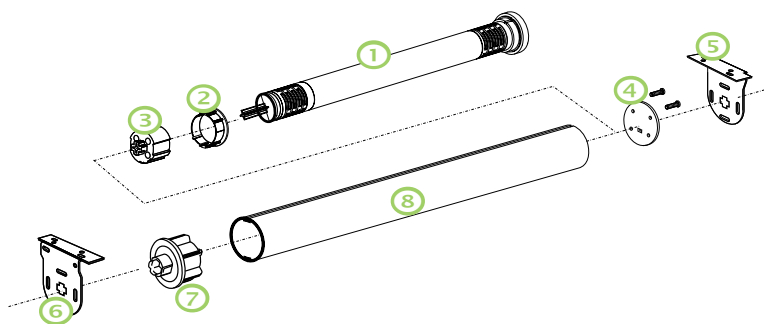

All parts listed above are available to purchase from Somfy.

COMMISSIONING TOOLS

Sonesse 30 DCT & RS485

REF: 9014599

Setting Tool

This setting tool allows the installer to set the limit positions and motor speed on the Sonesse 30 DCT or RS485 motors.



Sonesse 30 RTS

REF: 1810630

Telis 1 RTS Pure

RTS setting tool

Any Somfy RTS control can be used to set the motor stopping positions prior to terminating the motor supply cable to the main supply.



Telis 1
RTS Pure

SONESSE 30 SYSTEM PARTS

Sonesse 30 DCT

Ref: 1000668



Sonesse 30 RTS

Ref: 1001524



Sonesse 30 RS485

Ref: 1000658



Louvolite System 40[®] Motor Pack

Ref: 9014045

Description

This pack includes the motor crown & drive wheels for System 40[®] tube and a plate to secure the motor head to the motor bracket.

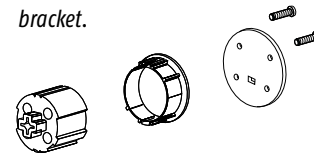

Louvolite System 40[®] Bracket Pack

Ref: 9016315

Description

This pack includes the motor & idle end brackets and the idle end for the System 40[®] tube and Sonesse 30 motor.

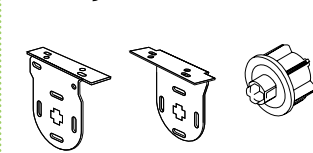

Louvolite System 40[®] Tube

Ref: 9016316

Description

Louvolite System 40[®] tube supplied in lengths of 2.5M.

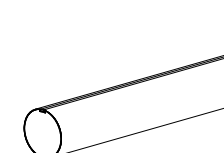

Sonesse 30 – 50mm Venetian blind selection charts and system parts

BLIND SELECTION CHARTS

The selection charts below are based on the specification of the Sonesse 30 motor for a 50mm Venetian blind using a 51 x 57 mm headrail and slat material of varying weight.

Cord Thickness = 1.4mm
Tube Diameter = 40mm octagonal
Slat Weight = 750 g/M²
Bottom Bar Weight = 500 g/M

DROP (M)	WIDTH (M)				
	0.6	1.2	1.8	2.4	3.0
0.6	SONESSE 30	CONTACT SOMFY	CONTACT SOMFY	CONTACT SOMFY	CONTACT SOMFY
1.2	SONESSE 30	CONTACT SOMFY	CONTACT SOMFY	CONTACT SOMFY	CONTACT SOMFY
1.8	SONESSE 30	CONTACT SOMFY	CONTACT SOMFY	CONTACT SOMFY	CONTACT SOMFY
2.4	SONESSE 30	CONTACT SOMFY	CONTACT SOMFY	CONTACT SOMFY	CONTACT SOMFY
3.0	SONESSE 30	CONTACT SOMFY	CONTACT SOMFY	CONTACT SOMFY	CONTACT SOMFY
3.6	SONESSE 30	CONTACT SOMFY	CONTACT SOMFY	CONTACT SOMFY	CONTACT SOMFY
4.2	SONESSE 30	CONTACT SOMFY	CONTACT SOMFY	CONTACT SOMFY	CONTACT SOMFY
4.8	SONESSE 30	CONTACT SOMFY	CONTACT SOMFY	CONTACT SOMFY	CONTACT SOMFY

Cord Thickness = 1.4mm
Tube Diameter = 40mm octagonal
Slat Weight = 1000 g/M²
Bottom Bar Weight = 500 g/M

DROP (M)	WIDTH (M)				
	0.6	1.2	1.8	2.4	3.0
0.6	SONESSE 30	CONTACT SOMFY	CONTACT SOMFY	CONTACT SOMFY	CONTACT SOMFY
1.2	SONESSE 30	CONTACT SOMFY	CONTACT SOMFY	CONTACT SOMFY	CONTACT SOMFY
1.8	SONESSE 30	CONTACT SOMFY	CONTACT SOMFY	CONTACT SOMFY	CONTACT SOMFY
2.4	SONESSE 30	CONTACT SOMFY	CONTACT SOMFY	CONTACT SOMFY	CONTACT SOMFY
3.0	SONESSE 30	CONTACT SOMFY	CONTACT SOMFY	CONTACT SOMFY	CONTACT SOMFY
3.6	SONESSE 30	CONTACT SOMFY	CONTACT SOMFY	CONTACT SOMFY	CONTACT SOMFY
4.2	SONESSE 30	CONTACT SOMFY	CONTACT SOMFY	CONTACT SOMFY	CONTACT SOMFY
4.8	SONESSE 30	CONTACT SOMFY	CONTACT SOMFY	CONTACT SOMFY	CONTACT SOMFY

Cord Thickness = 1.4mm
Tube Diameter = 40mm octagonal
Slat Weight = 1250 g/M²
Bottom Bar Weight = 500 g/M

DROP (M)	WIDTH (M)				
	0.6	1.2	1.8	2.4	3.0
0.6	SONESSE 30	CONTACT SOMFY	CONTACT SOMFY	CONTACT SOMFY	CONTACT SOMFY
1.2	SONESSE 30	CONTACT SOMFY	CONTACT SOMFY	CONTACT SOMFY	CONTACT SOMFY
1.8	SONESSE 30	CONTACT SOMFY	CONTACT SOMFY	CONTACT SOMFY	CONTACT SOMFY
2.4	SONESSE 30	CONTACT SOMFY	CONTACT SOMFY	CONTACT SOMFY	CONTACT SOMFY
3.0	SONESSE 30	CONTACT SOMFY	CONTACT SOMFY	CONTACT SOMFY	CONTACT SOMFY
3.6	SONESSE 30	CONTACT SOMFY	CONTACT SOMFY	CONTACT SOMFY	CONTACT SOMFY
4.2	SONESSE 30	CONTACT SOMFY	CONTACT SOMFY	CONTACT SOMFY	CONTACT SOMFY
4.8	SONESSE 30	CONTACT SOMFY	CONTACT SOMFY	CONTACT SOMFY	CONTACT SOMFY

Cord Thickness = 1.4mm
Tube Diameter = 40mm octagonal
Slat Weight = 1500 g/M²
Bottom Bar Weight = 500 g/M

DROP (M)	WIDTH (M)				
	0.6	1.2	1.8	2.4	3.0
0.6	SONESSE 30	CONTACT SOMFY	CONTACT SOMFY	CONTACT SOMFY	CONTACT SOMFY
1.2	SONESSE 30	CONTACT SOMFY	CONTACT SOMFY	CONTACT SOMFY	CONTACT SOMFY
1.8	SONESSE 30	CONTACT SOMFY	CONTACT SOMFY	CONTACT SOMFY	CONTACT SOMFY
2.4	SONESSE 30	CONTACT SOMFY	CONTACT SOMFY	CONTACT SOMFY	CONTACT SOMFY
3.0	SONESSE 30	CONTACT SOMFY	CONTACT SOMFY	CONTACT SOMFY	CONTACT SOMFY
3.6	SONESSE 30	CONTACT SOMFY	CONTACT SOMFY	CONTACT SOMFY	CONTACT SOMFY
4.2	SONESSE 30	CONTACT SOMFY	CONTACT SOMFY	CONTACT SOMFY	CONTACT SOMFY
4.8	SONESSE 30	CONTACT SOMFY	CONTACT SOMFY	CONTACT SOMFY	CONTACT SOMFY

Contact Somfy Customer Services for guidance on motor selection based on specific blind characteristics.

EXPLODED VIEW OF SONESSE 30 VENETIAN BLIND SYSTEM

PARTS LIST

1	Sonesse 30 motor
2	Ø40 conversion adapters
3	Crown wheel
4	Drive wheel
5	Motor & idle end bracket
6	Idle end
7	CTS40 cone
8	CTS40 bearing
9	40mm octagonal tube*
10	51 x 57 mm headrail*
11	Headrail end cap*

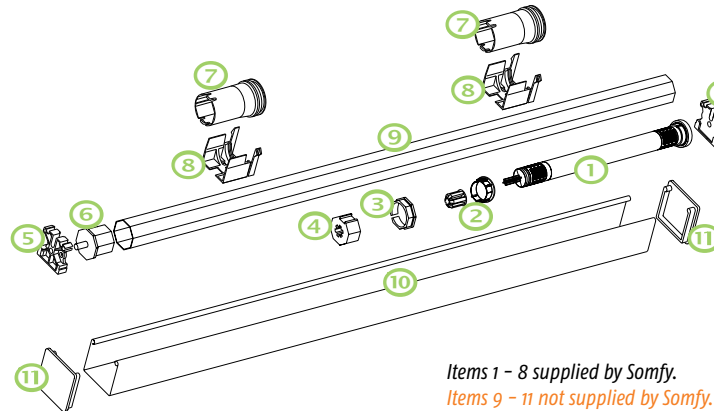

Items 1 – 8 supplied by Somfy.
Items 9 – 11 not supplied by Somfy.

COMMISSIONING TOOLS

Sonesse 30 DCT

REF: 9014599

Setting Tool

This setting tool allows the installer to set the limit positions and motor speed on the Sonesse 30 DCT or RS485 motors.



Sonesse 30 RTS

REF: 1810630

Telis 1 RTS Pure

RTS setting tool

Any Somfy RTS control can be used to set the motor stopping positions prior to terminating the motor supply cable to the main supply.



Telis 1
RTS Pure

SONESSE 30 50mm VENETIAN BLIND SYSTEM PARTS

SONESSE 30 MOTORS

MOTOR	REFERENCE
Sonesse 30 DCT	1000668
Sonesse 30 RTS	1001524
Sonesse 30 RS485	1000658

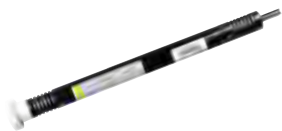

Ø40 conversion kit

Ref: 9013776

Description

Crown and drive adapters enabling the use of Ø40 components.

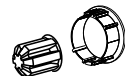

Crown wheel

Ref: 9147327

Description

Crown wheel for 40mm x 1.15mm octagonal tube.



Drive wheel

Ref: 9147545

Description

Drive wheel for 40mm x 1.15mm octagonal tube.



Motor & idle end bracket

Ref: 9500736

Description

Motor and idle end bracket suitable for 51 x 57 headrail.

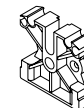

Idle end

Ref: 9137018

Description

Idle end to suit 40mm octagonal tube for use with CTS40 system.



CTS40 Cone

Ref: 9162144

Description

CTS40 cone for use with CTS40 system.



CTS40 Bearing

Ref: 9162145

Description

CTS40 support bearing to suit 51 x 57 mm headrail for use with CTS40 system.



DC POWER SUPPLIES

The Sonesse 30 is a DC motor and requires a 24Vdc supply feed. The following Somfy transformers (power supplies) convert a mains 230Vac input voltage down to a suitable 24Vdc supply voltage for the Sonesse 30 motor.

POWER 2.7 DC Ref: 1870156



NUMBER OF MOTORS THIS UNIT WILL POWER

Sonesse 30 DCT	2
Sonesse 30 RTS	1
Sonesse 30 RS485	1

DIMENSIONS

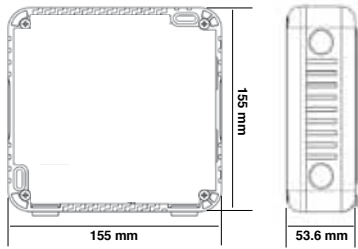

WIRING

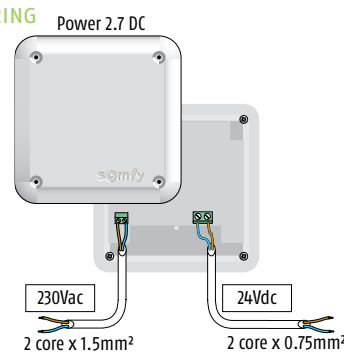

GPS 100 Ref: 1870035



NUMBER OF MOTORS THIS UNIT WILL POWER

Sonesse 30 DCT	2
Sonesse 30 RTS	2
Sonesse 30 RS485	2

DIMENSIONS

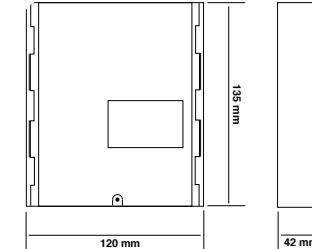

WIRING

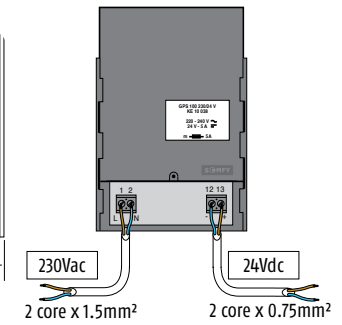

WIRING

Contact Closure Control

Sonesse 30 DCT Control Wiring
 White/Blue – Direction 1
 White/Orange – Direction 2
 Orange – GND
 Blue –STOP

Sonesse 30 DCT Control Connection

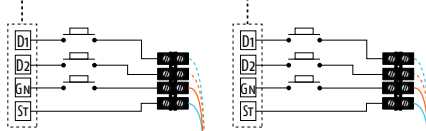

Note:
 A S/C across both UP & DOWN contact directions simultaneously will result in a STOP command.

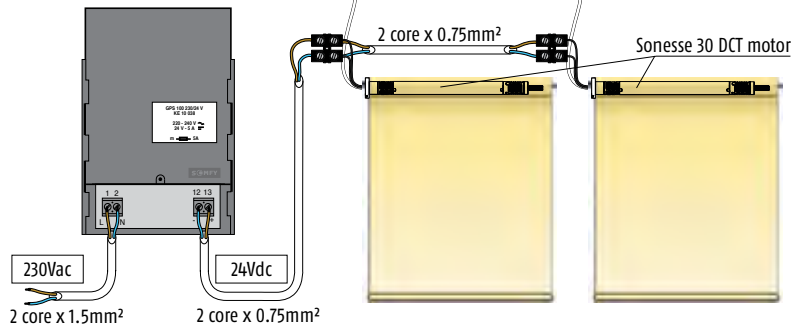

Wiring details for the GPS 100 power supply including the termination of the Sonesse 30 DCT motors. The GPS 100 is capable of powering 2 x Sonesse 30 DCT motors.

Sonesse 30 DCT Setting Tool

Ref: 9014599
 UP (White/Blue)
 STOP (Blue)
 DOWN (White/Orange)
 GND (Orange)



This setting tool is used to commission the motor stopping positions, adjust rotational direction/speed and set an intermediate stopping position.

Grey wire = +24 Vdc
 White wire = 0 Vdc

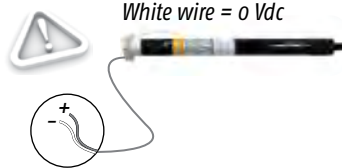

SONESSE 30 DCT CONTROL SCENARIO

Scenario based on 4 Sonesse 30 DCT motors controlled by a dry contact closure device.



Home Automation Control System



The Home Automation Control System and Dry Contact Closure Control Unit are third party products not supplied by Somfy.

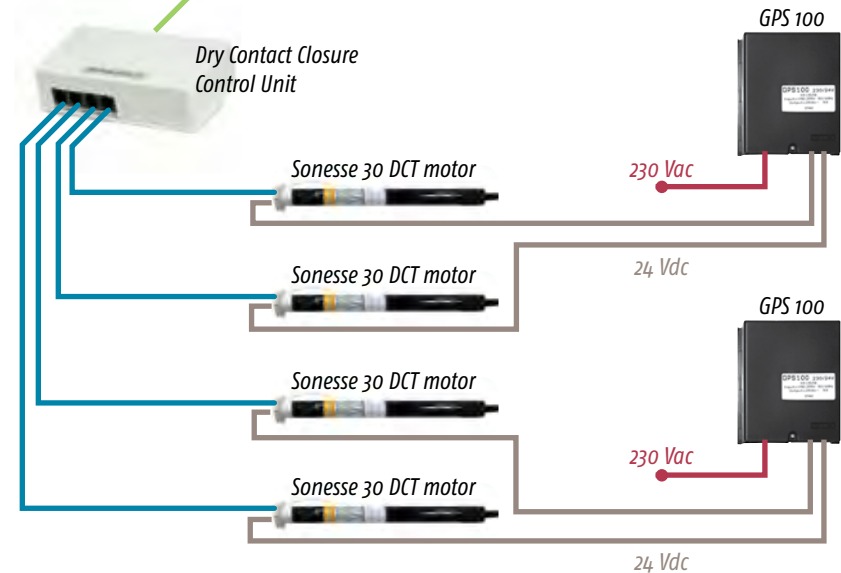

Sonesse 30 RTS – DC power supplies and system wiring

DC POWER SUPPLIES

The Sonesse 30 is a DC motor and requires a 24Vdc supply feed. The following Somfy transformers (power supplies) convert a mains 230Vac input voltage down to a suitable 24Vdc supply voltage for the Sonesse 30 motor.

POWER 2.7 DC

Ref: 1870156



NUMBER OF MOTORS THIS UNIT WILL POWER

Sonesse 30 DCT	2
Sonesse 30 RTS	1
Sonesse 30 RS485	1

DIMENSIONS

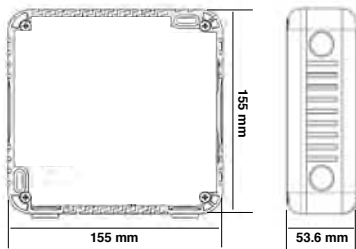

WIRING

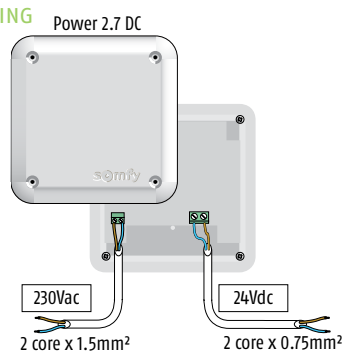

GPS 100

Ref: 1870035



NUMBER OF MOTORS THIS UNIT WILL POWER

Sonesse 30 DCT	2
Sonesse 30 RTS	2
Sonesse 30 RS485	2

DIMENSIONS

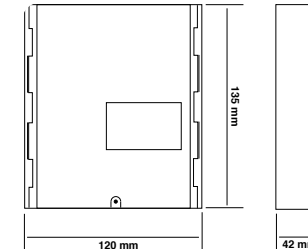

WIRING

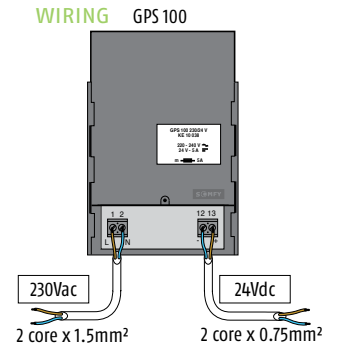

WIRING

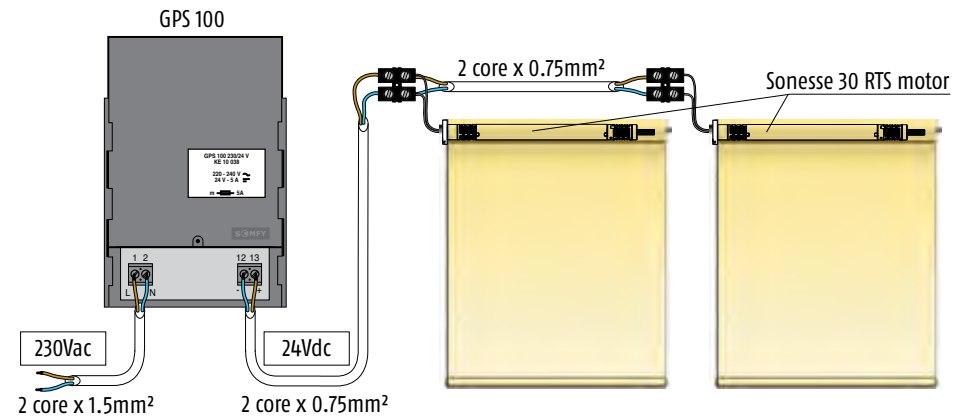

Wiring details for the GPS 100 power supply including the termination of the Sonesse 30 RTS motors. The GPS 100 is capable of powering 2 x Sonesse 30 motors.

Sonesse 30 RTS Setting Tool

Ref: 1810630

Telis 1 RTS Pure

N.B. Any Somfy RTS control can be used for the commissioning procedure.



A Somfy RTS controller is used to commission the motor stopping positions, adjust rotational direction/speed and set an intermediate stopping position.

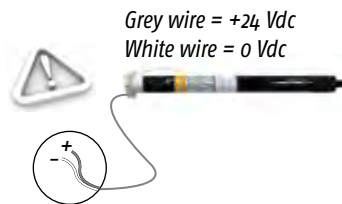

SONESSE 30 RTS CONTROL SCENARIO

Scenario based on 4 Sonesse 30 RTS motors controlled by a Somfy RS485 RTS transmitter and/or a RTS remote control.

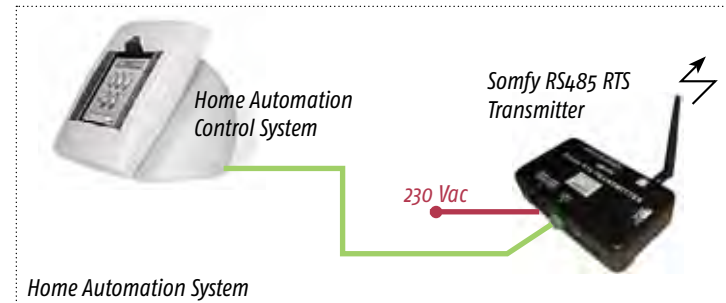

Home Automation System

The Home Automation Control System is a third party product not supplied by Somfy. See page x for details of the Somfy RS485 RTS transmitter.

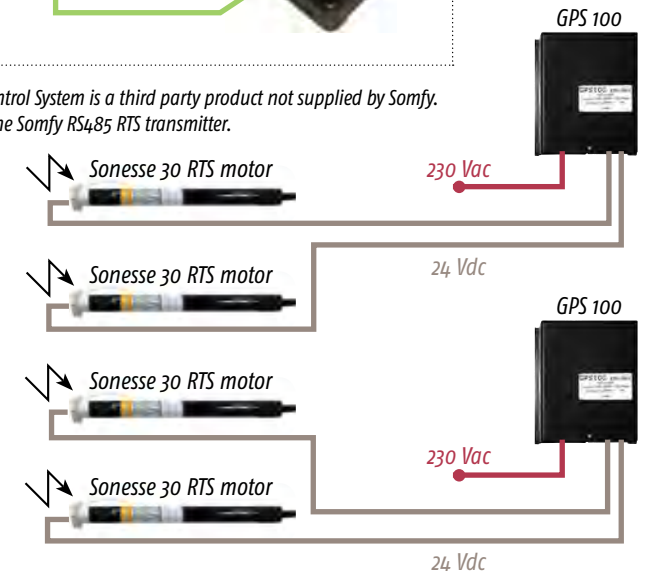

Sonesse 30 RS485 – DC power supplies and system wiring

DC POWER SUPPLIES

The Sonesse 30 is a DC motor and requires a 24Vdc supply feed. The following Somfy transformers (power supplies) convert a mains 230Vac input voltage down to a suitable 24Vdc supply voltage for the Sonesse 30 motor.

POWER 2.7 DC Ref: 1870156



NUMBER OF MOTORS THIS UNIT WILL POWER

Sonesse 30 DCT	2
Sonesse 30 RTS	1
Sonesse 30 RS485	1

DIMENSIONS

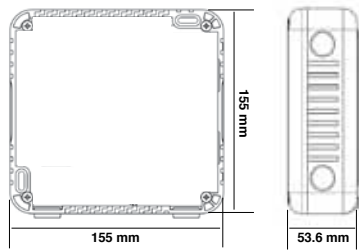

WIRING Power 2.7 DC

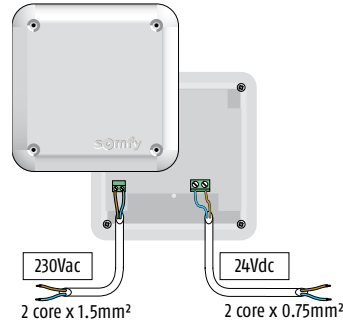

GPS 100 Ref: 1870035



NUMBER OF MOTORS THIS UNIT WILL POWER

Sonesse 30 DCT	2
Sonesse 30 RTS	2
Sonesse 30 RS485	2

DIMENSIONS

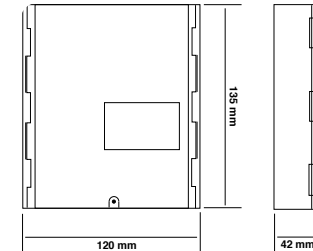

WIRING GPS 100

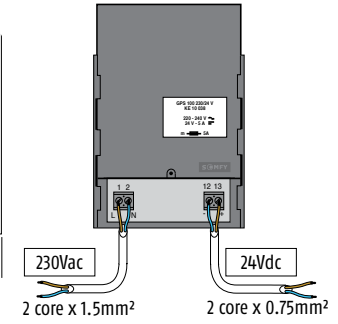

WIRING

Contact Closure Control

Sonesse 30 RS485 Control Wiring
White/Blue – Direction 1
White/Orange – Direction 2
Orange – GND
Blue – STOP

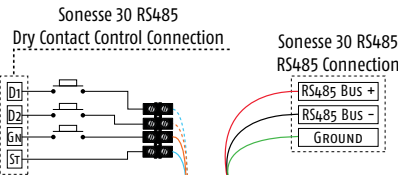

Note:
A S/C across both UP or DOWN contact directions simultaneously will result in a STOP command.

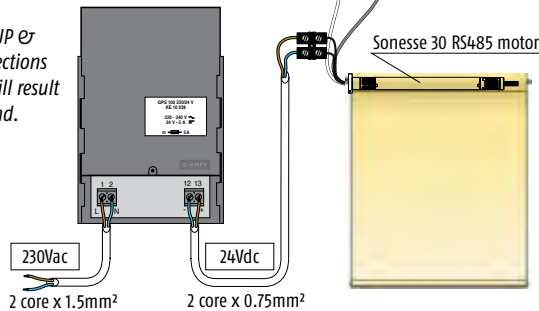

RS485 Control

Sonesse 30 RS485 Control Wiring
Red – RS485 Bus +
Black – RS485 Bus -
Green – Ground

Wiring details for the GPS 100 power supply including the termination of the Sonesse 30 RS485 motors. The GPS 100 is capable of powering 2 x Sonesse 30 RS485 motors.

Sonesse 30 RS485 Setting Tool

Ref: 9014599
UP (White/Blue)
STOP (Blue)
DOWN (White/Orange)
GND (Orange)

This setting tool can be used to commission the motor stopping positions, adjust rotational direction/speed and set an intermediate stopping position.

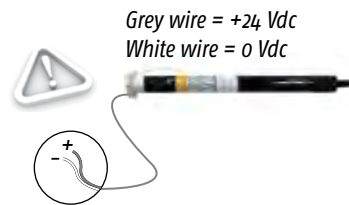

SONESSE 30 DCT CONTROL SCENARIO

Scenario based on 4 Sonesse 30 RS485 motors controlled by a RS485 home automation device.



The Home Automation Control System and RS485 Control Unit are third party products not supplied by Somfy.

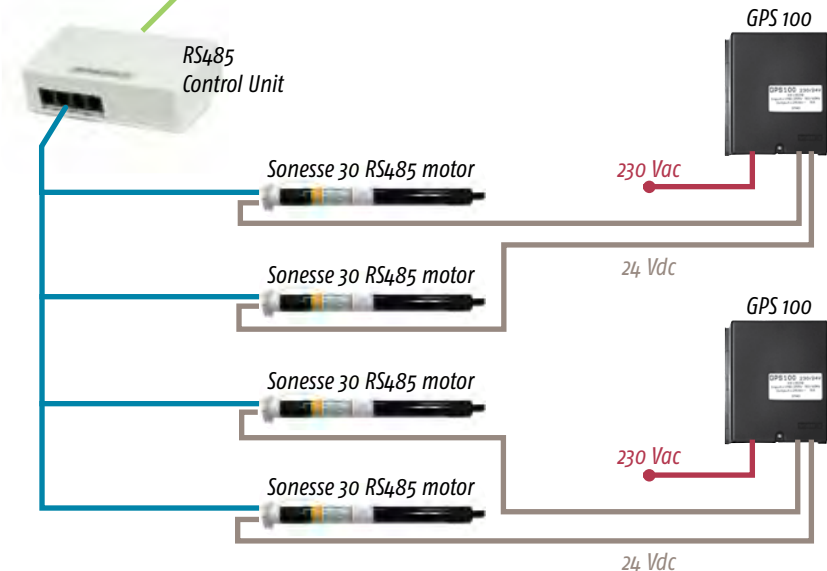

Sonesse 40 Range

TECHNICAL SPECIFICATION – SONESSE 40 WT

Sonesse 40 WT



Features & Benefits

230 Vac quiet operation tubular motor incorporating an integral brake and mechanical limit switch unit with progressive set limit adjusters for accurate stopping positions. Suitable for use with aluminium tubes with minimum diameter of 40mm. The Sonesse 40 WT motor is controlled via a 230Vac feed across the motor neutral and direction wires. This motor is a Class II product and therefore does not require an earth connection.

DIMENSIONS

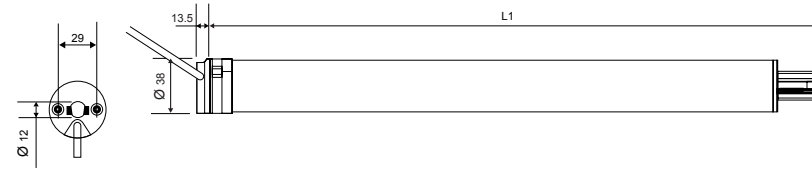

MOTOR	TORQUE	SPEED	LENGTH L1	CURRENT	POWER
Sonesse 40 1.3/55	1.3 NM	55 RPM			
Sonesse 40 3/30	3 NM	30 RPM	478	440mA	100W
Sonesse 40 6/20	6 NM	20 RPM	510	550mA	130W
Sonesse 40 9/12	9 NM	12 RPM	510	550mA	130W

MOTOR FUNCTIONALITY

- Quiet motor
- Progressive limit adjustment
- Double insulation
- 230Vac control
- 5 year warranty

TECHNICAL CHARACTERISTICS

Power supply voltage	230 Vac
Power supply tolerance	207 - 244 Vac
Sound level	44 dBA
Limit switch type	Mechanical
Limit switch capacity	40 turns
Operating temperature	0°C to 60°C
Thermal time	4 minutes
Protection factor	IP 31
Insulation class	Class II
Supply cable type	3 core 0.75mm ²
Supply cable length	2.5M

TECHNICAL SPECIFICATION – SONESSE 40 RTS

Sonesse 40 RTS



Features & Benefits

230 Vac quiet operation tubular motor incorporating an integral brake and electronic limit switch unit for accurate stopping positions. Suitable for use with aluminium tubes with minimum diameter of 40mm. The Sonesse 40 RTS motor is controlled via Somfy RTS radio signalling. This motor is a Class II product and therefore does not require an earth connection.

DIMENSIONS

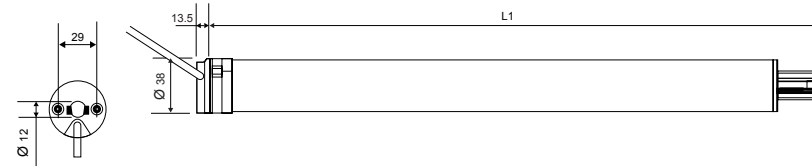

MOTOR	TORQUE	SPEED	LENGTH L1	CURRENT	POWER
Sonesse 40 RTS 3/30	3 NM	30 RPM	478	440mA	100W
Sonesse 40 RTS 6/20	6 NM	20 RPM	510	550mA	130W
Sonesse 40 RTS 9/12	9 NM	12 RPM	510	550mA	130W

MOTOR FUNCTIONALITY

- Quiet motor
- Electronic limit adjustment
- Double insulation
- RTS radio signalling
- 5 year warranty

TECHNICAL CHARACTERISTICS

Power supply voltage	230 Vac
Power supply tolerance	207 - 244 Vac
Sound level	44 dBA
Limit switch type	Electronic
Limit switch capacity	3 mins of rotation
Operating temperature	0°C to 60°C
Thermal time	4 minutes
Radio frequency	433.43 Mhz
Radio coding	Rolling code
Radio range - unobstructed	200M
Radio range - obstructed	20M
RTS control capacity	12 RTS controls
RTS sensor capacity	3 RTS sensors
Protection factor	IP 31
Insulation class	Class II
Supply cable type	2 core 0.75mm ²
Supply cable length	2.5M

BLIND SELECTION CHARTS

The selection charts below are based on the specification of the Sonesse 40 motor using 40mm x 1.5mm round tube and fabric of varying weight. Maximum tube width is 3.6M.

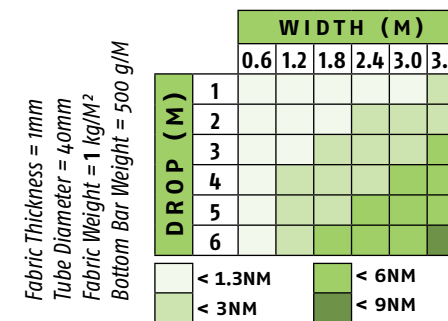
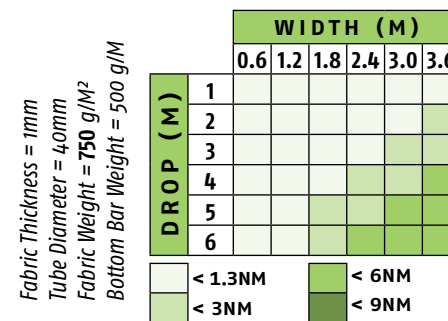
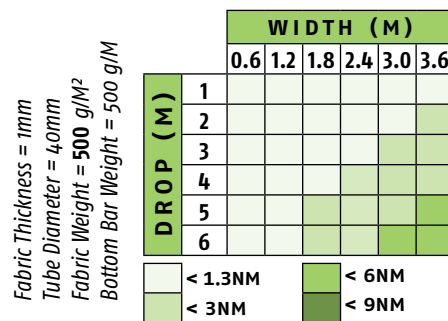
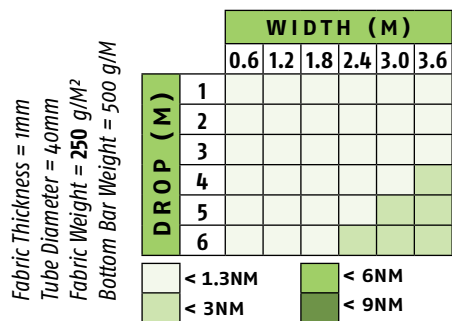

Contact Somfy Customer Services for guidance on motor selection based on specific fabric characteristics.

EXPLODED VIEW OF SONESSE 40 ROLLER BLIND SYSTEM

PARTS LIST

1	Sonesse 40 motor
2	Crown wheel
3	Drive wheel
4	Motor bracket
5	Idle end bracket
6	Idle end
7	Tube

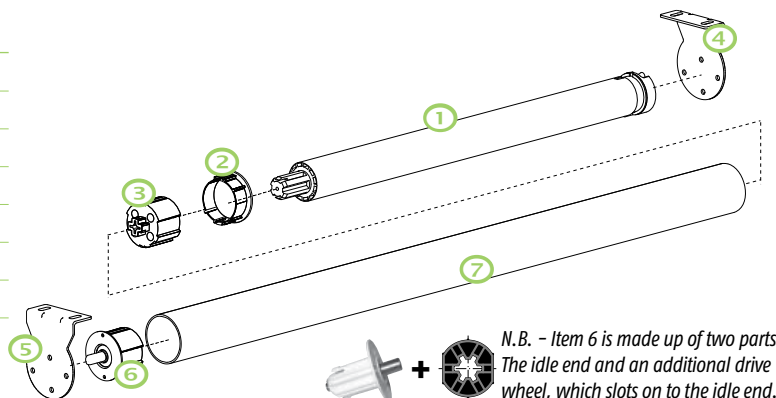

Items 1 – 6 supplied by Somfy.
Item 7 not supplied by Somfy.

N.B. – Item 6 is made up of two parts.
The idle end and an additional drive wheel, which slots on to the idle end.

COMMISSIONING TOOLS

Sonesse 40 WT

REF: 9686030

Test lead

This test lead allows the installer to operate the motor in a controlled manner using the integral switch and set the motor stopping positions prior to terminating the motor supply cable to the designated control system.

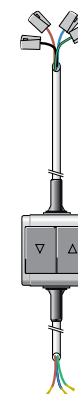

Sonesse 40 RTS

REF: 1810630

Telis 1 RTS Pure

RTS setting tool

Any Somfy RTS control can be used to set the motor stopping positions prior to terminating the motor supply cable to the main supply.



Telis 1
RTS Pure

SONESSE 40 ROLLER BLIND SYSTEM PARTS

SONESSE 40 WT MOTORS

MOTOR	REFERENCE
Sonesse 40 1.3/55 WT	1001545
Sonesse 40 3/30 WT	1001547
Sonesse 40 6/20 WT	1001550
Sonesse 40 9/14 WT	1001551

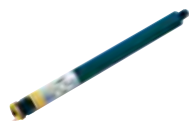

SONESSE 40 RTS MOTORS

MOTOR	REFERENCE
Sonesse 40 3/30 RTS	1001573
Sonesse 40 6/20 RTS	1001577
Sonesse 40 9/14 RTS	1001581

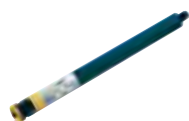

Crown wheel

Ref: 9147330

Description

Sonesse 40 crown wheel for 40mm x 1.5mm round tube.

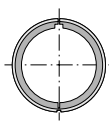

Drive wheel

Ref: 9147544

Description

Sonesse 40 drive-wheel for 40mm x 1.5mm round tube.



Motor bracket

Ref: 9500683

Description

Sonesse 40 motor bracket suitable for wall and ceiling mounting.



Idle end bracket

Ref: 9500685

Description

Sonesse 40 idle end bracket suitable for wall and ceiling mounting.



Idle end

Ref: 9500688

Description

Sonesse 40 idle end to suit idle end bracket 9500685 (drive wheel required to create idle end kit).



Order 9147544 to make Idle end kit.

Tube

Description

40mm x 1.5mm round tube. Not supplied by Somfy.



Sonesse 40 – 50mm Venetian blind selection charts and system parts

BLIND SELECTION CHARTS

The selection charts below are based on the specification of the Sonesse 40 motor for a 50mm Venetian blind using a 51 x 57 mm headrail and slat material of varying weight.

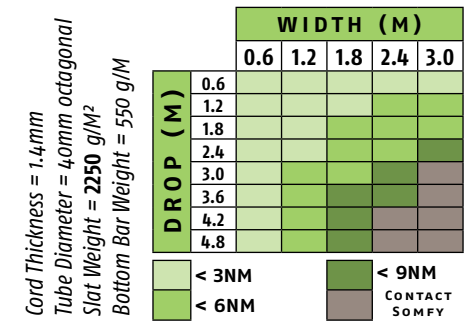
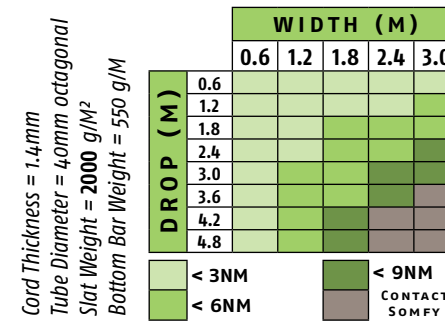
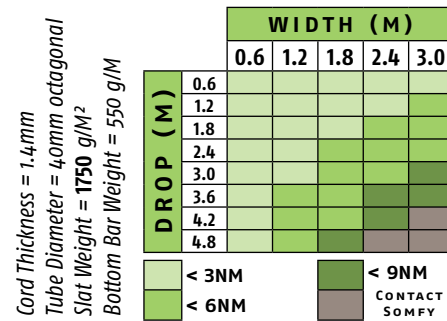
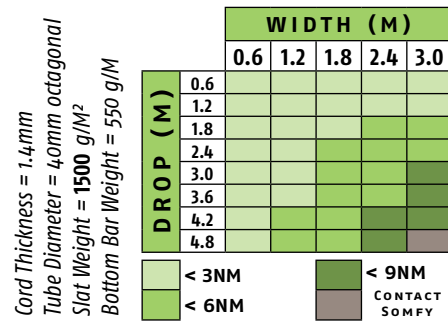

Contact Somfy Customer Services for guidance on motor selection based on specific blind characteristics.

EXPLODED VIEW OF SONESSE 40 50MM VENETIAN BLIND SYSTEM

PARTS LIST

1	Sonesse 40 motor
2	Crown wheel
3	Drive wheel
4	Motor & idle end bracket
5	Idle end
6	CTS40 cone
7	CTS40 bearing
8	40mm octagonal tube
9	51 x 57 mm headrail
10	Headrail end cap

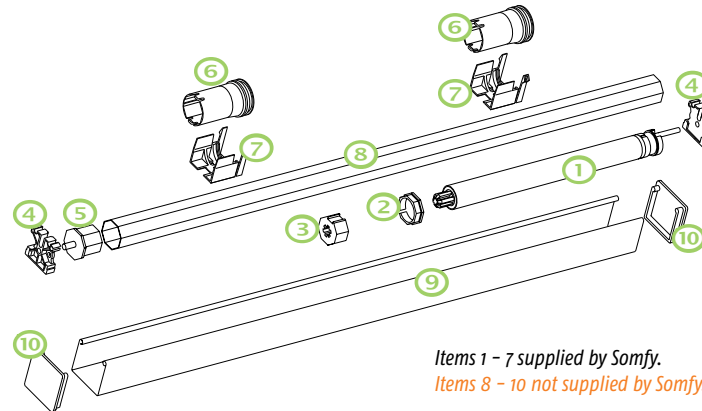

Items 1 – 7 supplied by Somfy.
 Items 8 – 10 not supplied by Somfy.

COMMISSIONING TOOLS

Sonesse 40 WT

REF: 9686030

Test lead

This test lead allows the installer to operate the motor in a controlled manner using the integral switch and set the motor stopping positions prior to terminating the motor supply cable to the designated control system.

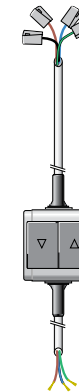

Sonesse 40 RTS

REF: 1810630

Telis 1 RTS Pure

RTS setting tool

Any Somfy RTS control can be used to set the motor stopping positions prior to terminating the motor supply cable to the main supply.



Telis 1
RTS Pure

SONESSE 40 ROLLER BLIND SYSTEM PARTS

SONESSE 40 WT MOTORS

MOTOR	REFERENCE
Sonesse 40 1.3/55 WT	1001545
Sonesse 40 3/30 WT	1001547
Sonesse 40 6/20 WT	1001550
Sonesse 40 9/14 WT	1001551

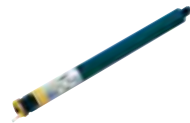

SONESSE 40 RTS MOTORS

MOTOR	REFERENCE
Sonesse 40 3/30 RTS	1001573
Sonesse 40 6/20 RTS	1001577
Sonesse 40 9/14 RTS	1001581



Crown wheel

Ref: 9147327

Description

Crown wheel for 40mm x 1.15mm octagonal tube.



Drive wheel

Ref: 9147545

Description

Drive wheel for 40mm x 1.15mm octagonal tube.



Motor & idle end bracket

Ref: 9500736

Description

Motor and idle end bracket suitable for 51 x 57 headrail.

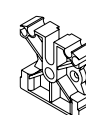

Idle end

Ref: 9137018

Description

Idle end to suit 40mm octagonal tube for use with CTS40 system.



CTS40 Cone

Ref: 9162144

Description

CTS40 cone for use with CTS40 system.



CTS40 Bearing

Ref: 9162145

Description

CTS40 support bearing to suit 51 x 57 mm headrail for use with CTS40 system.



WIRING RECOMMENDATIONS

The Sonesse 40 WT is an AC motor and requires a 230Vac supply feed across the neutral and one direction at a time to raise and lower a roller blind.

PARALLEL WIRING

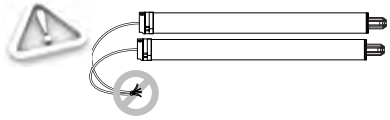

Wiring multiple Sonesse 40 WT's in parallel will result in damage to the motor.

For group motor control, an appropriate control unit (such as a relay, designed for use with tubular motors, which isolates each motor connection) must be used to prevent this and ensure correct operation.

ANIMEO CONTROL UNIT

The Animeo control unit provides individual and/or group control for up to 4 Sonesse 40 WT motors. Multiple Animeo controllers can be linked together to provide control of larger motorised blinds groups. The Animeo motor controllers are available as a wall or din rail mount unit. Both units are switched by dry contact closure signals, which can be configured to provide:

- Group control of all 4 motors
- Group and individual control of the 4 motors
- Group splitting for control of 3 @ 1 or 2 @ 2
- A RTS card can also be added to provide radio control

INFORMATION



Animeo 4AC MoCo
Wall mount version
Ref 1860049
Dimensions – 255 x 180 x 63 mm



Animeo 4AC MoCo
RTS Card
Ref 1860105



Animeo 4AC MoCo
Din rail mount version
Ref 1860081
Dimensions – 210 x 90 x 61 mm

WIRING

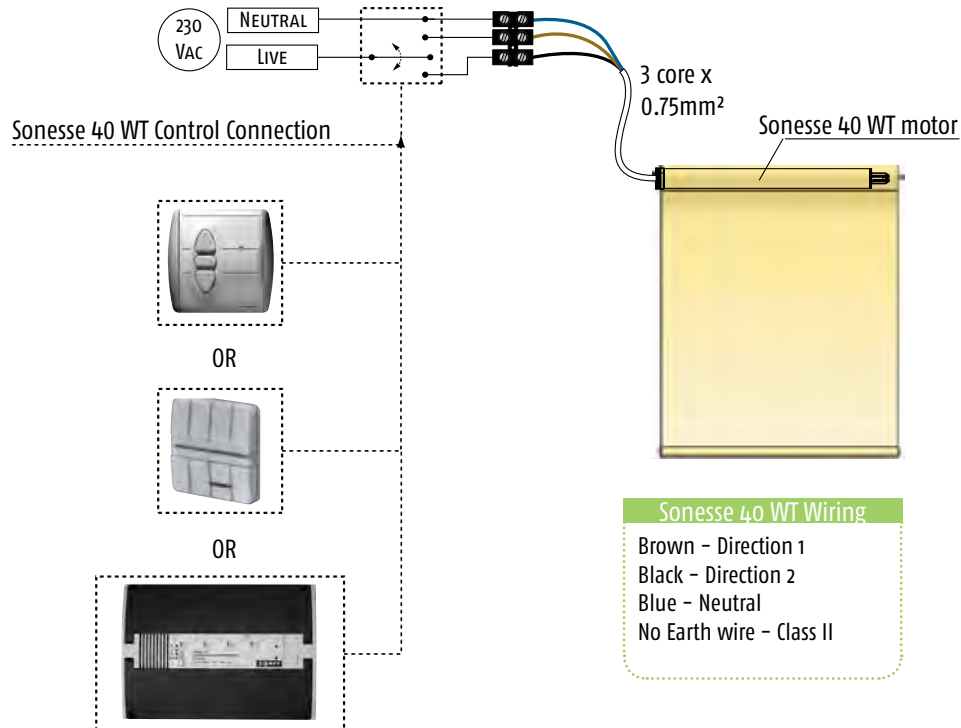

SONESSE 40 WT CONTROL SCENARIO

Scenario based on 4 Sonesse 40 WT motors controlled by a home automation device.

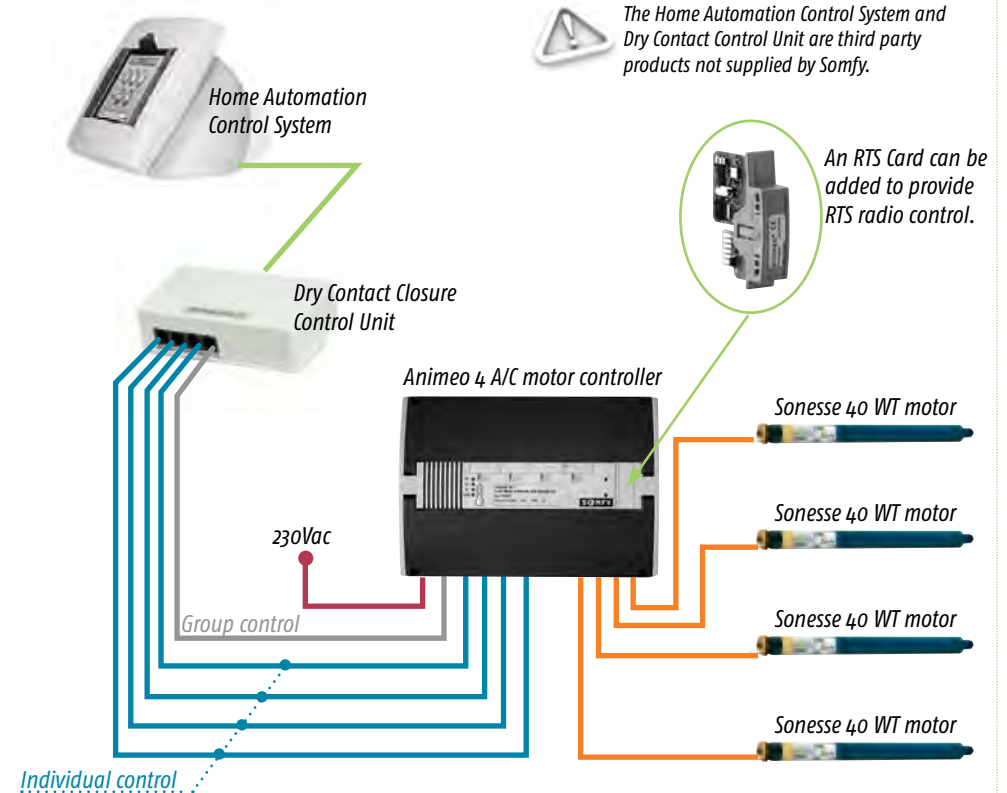

Sonesse 40 RTS - System wiring

WIRING RECOMMENDATIONS

The Sonesse 40 RTS is a AC motor and requires a 230Vac supply feed across the neutral and live to provide operational control.

PARALLEL WIRING

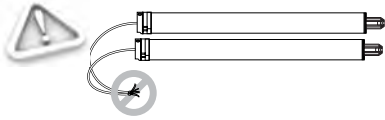

Wiring multiple Sonesse 40 RTS motors in parallel will complicate the commissioning procedure and result in difficulty when future maintenance work determines that the motor must be disconnected from the mains. We recommend that a separate switched fuse spur is specified for every Sonesse 40 RTS mains supply connection.

SONESSE 40 RTS

Sonesse 40 RTS motors have an integral radio receiver, that enables control via radio signalling. The commissioning process can configure the motorised blinds for different scenarios depending on the project requirement.

WIRING

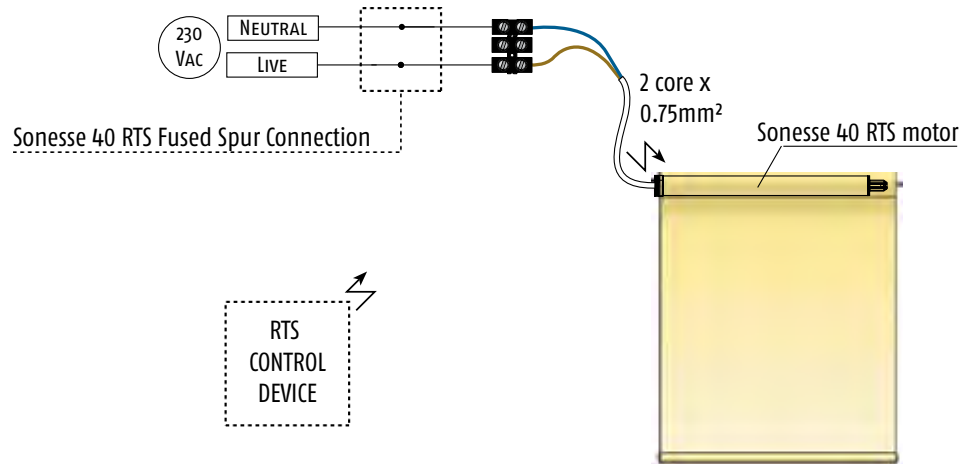

Sonesse 40 RTS Wiring

Brown - Live
Blue - Neutral
No Earth wire - Class II

SONESSE 40 RTS CONTROL SCENARIO

Scenario based on 4 Sonesse 40 RTS motors controlled by a home automation system.

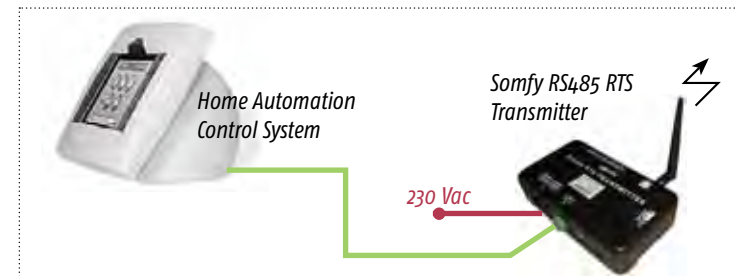

The Home Automation Control System is a third party product not supplied by Somfy.

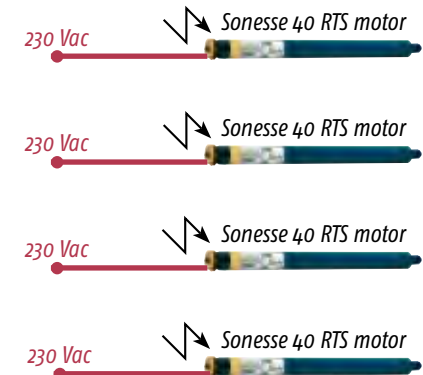

TECHNICAL SPECIFICATION

RS485 RTS Transmitter

Ref: 1810803



DIMENSIONS

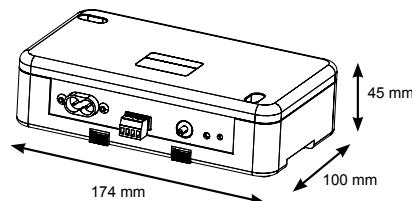

TECHNICAL CHARACTERISTICS

Supply voltage	230 Vac
Supply tolerance	90 - 255 Vac
Power consumption	3W max
Radio frequency	433.42 MHz
Radio range - unobstructed	200M
Radio range - obstructed	20M
RS485 connection	4-way terminal block (4 x 3.5mm)
Dry contact connection	5 x 3-way terminal block (3 x 3.5mm)
Antenna	BNC coaxial
Operating temperature	0°C to 60°C
Index protection	IP 20
Mounting options	Wall or DIN rail
Supply cable type	2 core 0.75mm ²
Supply cable length	2M
Colour	Black

Features & Benefits

The RS485 RTS Transmitter is designed to interface with home automation control units to provide control of Somfy RTS powered applications (blinds, awnings, roller shutters, etc.). This is achieved via 16 RTS channels available with RS485 signalling or 5 RTS channels with dry contact signalling. This unit is mains powered and can be mounted directly to the fixing surface such as a wall or din rail panel mounted. It is supplied with a BNC antenna capable of transmitting Somfy RTS signals 200M in free space or 20M through 2 concrete walls.

CONTROL FUNCTIONALITY

- 230Vac supply
- 16 RTS channels via RS485 signalling
- 5 RTS channels via dry contact signalling
- 5 year warranty

WIRING - RS485

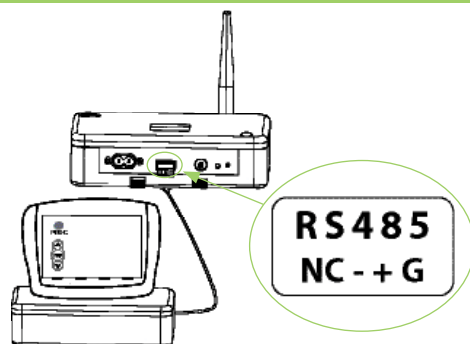

RS485 RTS Transmitter Wiring

- 'NC' - Not connected
- '-' - RS485 Bus -
- '+' - RS485 Bus +
- 'G' - Ground

RS485 RTS TRANSMITTER CONTROL SCENARIO

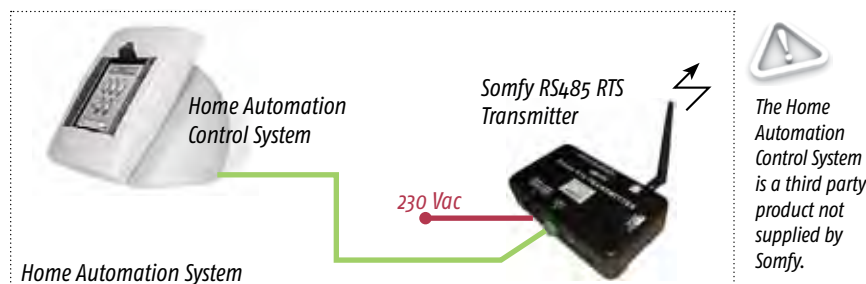

WIRING - DRY CONTACT

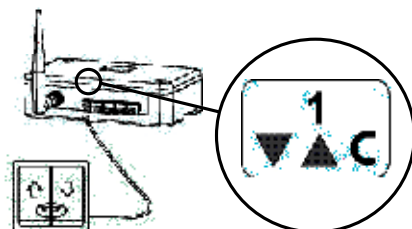

Dry Contact Wiring

- '▼' - Down directional wire
- '▲' - Up directional wire
- 'C' - Common

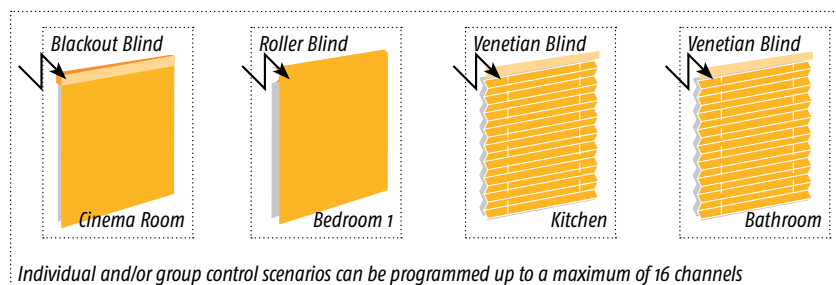

Dry Contact Transmitter

TECHNICAL SPECIFICATION

Dry Contact Transmitter

Ref: 1810334



DIMENSIONS

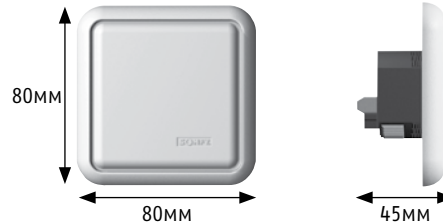

TECHNICAL CHARACTERISTICS

Supply voltage	230 Vac
Supply tolerance	205 - 255 Vac
Radio frequency	433.42 MHz
Radio range - unobstructed	200M
Radio range - obstructed	20M
Operating temperature	5°C to 40°C
Index protection	IP 30
Mounting options	Recess (flush) or Wall Mount
Colour	White

Features & Benefits

The Dry Contact Transmitter is designed to interface with home automation control units to provide control of Somfy RTS powered applications (blinds, awnings, roller shutters, etc.). This is achieved with a dry contact input to provide a single channel RTS radio signal. This unit is mains powered and can be mounted directly to the fixing surface by using a surface mounted box or recess mounted into a standard electrical back box. The radio range is 200M in free space or 20M through 2 concrete walls.

CONTROL FUNCTIONALITY

- 230Vac supply
- Single RTS channel via dry contact signal
- Surface or flush mount options
- 5 year warranty



Surface Mounting Box

Ref 9154122

Accessory required when surface mounting the Dry Contact Transmitter.

WIRING

Home Automation Control Connection

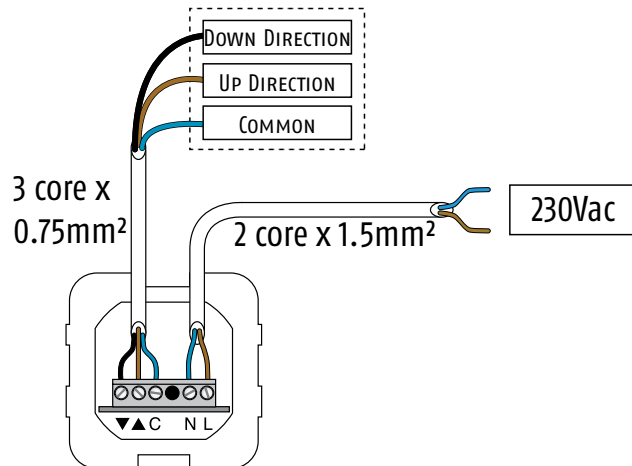

Dry Contact Wiring

- '▼' - Down directional wire
- '▲' - Up directional wire
- 'C' - Common

DRY CONTACT TRANSMITTER CONTROL SCENARIO

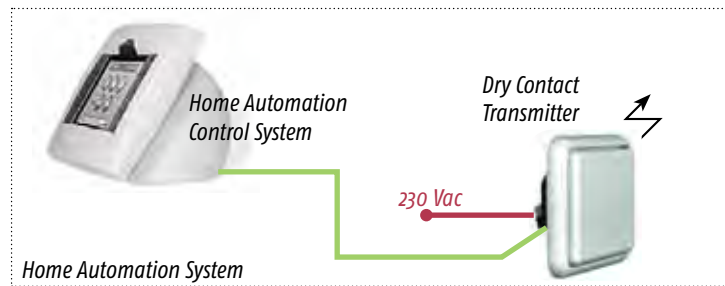

The Home Automation Control System is a third party product not supplied by Somfy.

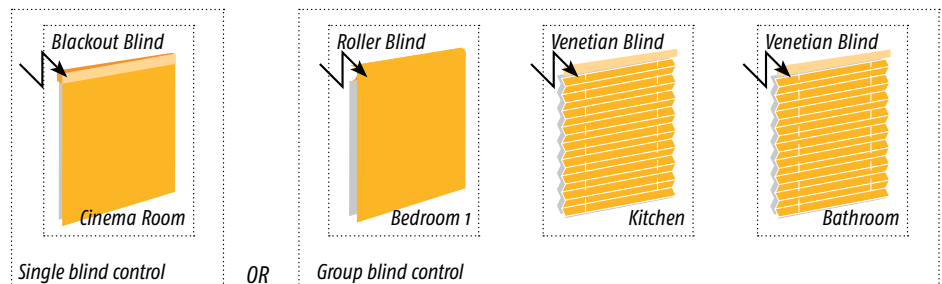

TELIS 1 RTS	
Single channel RTS transmitter	
Telis 1 RTS Pure	Ref. 1 810 630
Telis 1 RTS Patio	Ref. 1 810 642
Telis 1 RTS Silver	Ref. 1 810 637
Telis 1 RTS Lounge	Ref. 1 810 649

TELIS 4 RTS	
Multi channel RTS transmitter	
Telis 4 RTS Pure	Ref. 1 810 631
Patio	Ref. 1 810 644
Silver	Ref. 1 810 638
Lounge	Ref. 1 810 651

TELIS 1 MODULIS RTS	
Single channel Modulis RTS transmitter	
Telis 1 Modulis RTS Pure	Ref. 1 810 974
Telis 1 Modulis RTS Silver	Ref. 1 810 975

TELIS 4 MODULIS RTS	
Multi channel Modulis RTS transmitter	
Telis 4 Modulis RTS Pure	Ref. 1 810 765
Telis 4 Modulis RTS Silver	Ref. 1 810 663

SMOOVE 1 RTS	
Single channel RTS wall switch module	
Smoove 1 RTS Pure	Ref. 1 810 881
Smoove 1 RTS Black	Ref. 1 810 882
Smoove 1 RTS Silver	Ref. 1 810 883
Smoove 1 RTS Red	Ref. 1 810 884

SMOOVE 4 RTS	
Multi channel RTS wall switch module	
Smoove 4 RTS Pure	Ref. 1 810 888
Smoove 4 RTS Black	Ref. 1 810 887
Smoove 4 RTS Silver	Ref. 1 810 886
Smoove 4 RTS Red	Ref. 1 810 885

SMOOVE FRAMES	
Smoove wall switch module frame	
Pure finish	Ref. 9 015 022
Black finish	Ref. 9 015 023
Silver finish	Ref. 9 015 024
Matt silver finish	Ref. 9 015 025

TELIS 16 RTS & TELIS 6 CHRONIS RTS	
Telis 16 RTS transmitter	
Telis 16 RTS Pure	Ref. 1 811 020
Telis 16 RTS Silver	Ref. 1 811 021
Telis 6 Chronis RTS transmitter	
Telis 6 Chronis RTS Pure	Ref. 1 805 209
Telis 6 Chronis RTS Silver	Ref. 1 805 210



Customer order form

Fax back to Somfy on - 0113 391 3010

INVOICE TO

DELIVERY ADDRESS

Company name:

Company name:

Address:

Address:

Tel.:

Tel.:

Fax:

Fax:

Contact:

Contact:

DATE..... CUSTOMER N°

YOUR REFERENCE

Customers who do not hold an account must purchase orders pro-forma via credit card payment before any goods are dispatched. Contact our Customer Services Department for more information. All prices subject to VAT and delivery charges (delivery is FREE on all orders over £500).

Order form

SONESSE 30 MOTOR SYSTEMS				SONESSE 40 MOTOR SYSTEMS					
REFERENCE	DESCRIPTION	PRICE	QUANTITY	TOTAL	REFERENCE	DESCRIPTION	PRICE	QUANTITY	TOTAL
<i>Motors</i>									
1000668	Sonesse 30 DCT				1001545	Sonesse 40 1.3/55 WT			
1001524	Sonesse 30 RTS				1001547	Sonesse 40 3/30 WT			
1000658	Sonesse 30 RS485				1001550	Sonesse 40 6/20 WT			
<i>Roller blind components</i>									
9014045	System 40 motor pack				1001551	Sonesse 40 9/14 WT			
9147545	System 40 bracket pack				1001573	Sonesse 40 3/30 RTS			
9016316	System 40 tube (2.5M)				1001577	Sonesse 40 6/20 RTS			
<i>50mm venetian blind components</i>									
9013776	Ø40 conversion adapters				1001581	Sonesse 40 9/14 RTS			
9147327	40mm oct crown wheel				<i>Roller blind components</i>				
9147545	40mm oct drive wheel				9147330	40mm rnd crown wheel			
9500736	Motor & idle end bracket				9147544	40mm rnd drive wheel			
9137018	40mm oct idle end				9500683	Motor bracket			
9162144	CTS40 cone				9500685	Idle end bracket			
9162145	CTS40 bearing				9500688	Idle end			
<i>Power supplies</i>									
1870156	Power 2.7 DC				<i>50mm venetian blind components</i>				
1870035	GPS 100				9147327	40mm oct crown wheel			
<i>Commissioning tool</i>									
9014599	DCT & RS485 com tool				9147545	40mm oct drive wheel			
CONTROLS									
REFERENCE	DESCRIPTION	PRICE	QUANTITY	TOTAL	REFERENCE	DESCRIPTION	PRICE	QUANTITY	TOTAL
1810803	RS485 RTS Transmitter				9500736	Motor & idle end bracket			
1810334	Dry Contact Transmitter				9137018	40mm oct idle end			
9154122	Surface box for 1810334				9162144	CTS40 cone			
OTHER									
1860049	Animeo 4AC moco - wall				9162145	CTS40 bearing			
1860081	Animeo 4AC moco - rail								
1860105	Animeo moco RTS card								
REFERENCE	DESCRIPTION	PRICE	QUANTITY	TOTAL	REFERENCE	DESCRIPTION	PRICE	QUANTITY	TOTAL
				TOTAL					

Do you have questions or need help? Contact Somfy Customer Services on 0113 301 3030 or email sales.uk@somfy.com.

Tick this box if you require us to call you back to obtain credit card details for payment.

Area with horizontal dotted lines for notes.

Somfy Ltd
Moorfield Road
Yeadon
Leeds
West Yorkshire
LS19 7BN
T. 0113 391 3030
F. 0113 391 3010
E. sales.uk@somfy.com